

HDG ENGINEERED PRODUCTS

SERIES 2: CORNER BEAM BRACKET ASSEMBLY GUIDE

Structural Deck Support System: Product Numbers: H1-GQ, H2-GCL, & H2-GCR

STEP 1: Lay framing upon constructed beam and ledger. A cantilevered deck is used to display the function of this bracket. It can be used for similar purposes. In this case, we are using (2) 2x12's for beam and rim joist. Nail overlapped boards typically to hold them in place.

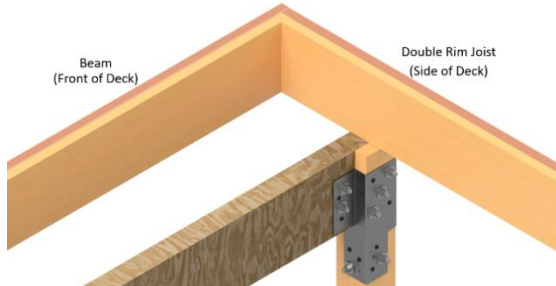

STEP 2: Place the H2-GCB bracket flush against corner, ensuring the bracket is flush along the bottom of the rim joist and beam (Optional: Can use screws or nails to temporarily hold in place).

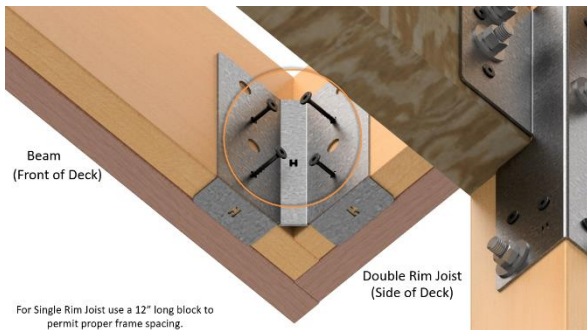

STEP 3: Cut 4x4 handrail posts and toenail or clamp them so that they align with the bolt holes on the bracket side flanges.

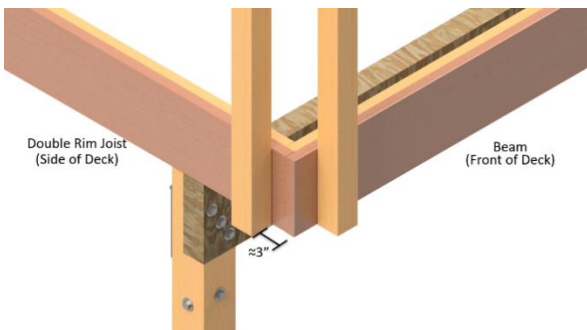

STEP 4: Drill, using each bolt hole in bracket as guides, through all lumber with a minimum 1/2" hole for 1/2" bolts or 5/8" hole for 5/8" bolts.

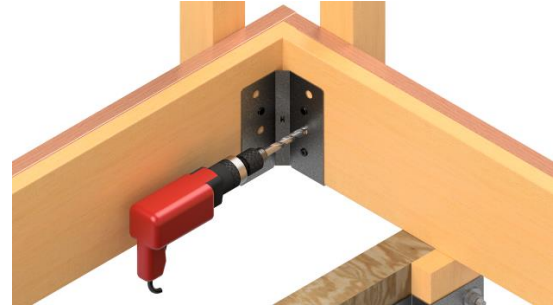

STEP 5: Installing bolts through the outside, fasten them inside the deck with code approved fasteners.

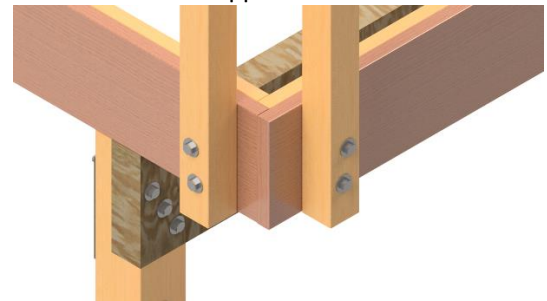

STEP 6: Torque per recommended wood council specs. Bolts are 1/2" diameter minimum. A307 bolts 5/8" thick should be torqued to 73 ft./lbs. A 307 bolts 1/2" thick should be torqued to 37 ft./lbs.

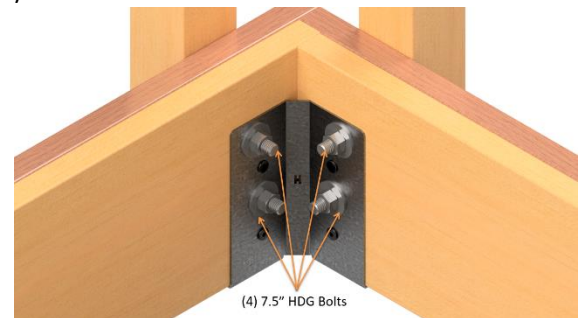

STEP 7: Installation Complete!

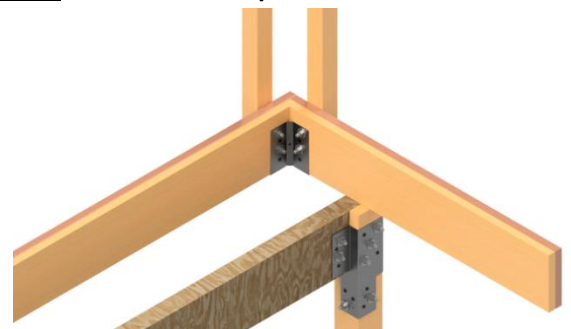

FOR ILLUSTRATED PURPOSES ONLY: SEE ADDITIONAL GUIDELINES PER DECK DESIGN PROFESSIONAL & LOCAL CODE AUTHORITY. INSTALLER IS RESPONSIBLE FOR PREVENTING WATER INTRUSION. TIGHTEN ALL BOLTS & SEAL ALL CAULK. FASTENERS MUST MEET OR EXCEED LOCAL CODE (REC: HDG ASTM 123 HOT DIPPED GALVANIZED OR STAINLESS STEEL) INSTALL ONLY IN PROVIDED, SPECIFIED HOLES. SEE HDGEP.COM FOR SPECS/VIDEOS